

# AUTOMATED STORM TANK WASHER

- **Powerful cleaning action**  
Removes soil, fats and screenings efficiently from tank benching and walls
- **Fully automatic system**  
No operator intervention needed
- **Effective odour control**  
Tank will be left free of odourous material
- **Ideal for retention sewers**  
Highly cost effective solution to cleaning systems that would normally require man entry.
- **Very low operating life cost**  
<£9 per wash cycle with a single wash head and practically maintenance free



### Versatile and Unique

The TANKMASTER is used within open or closed storm tanks to remove solids that are left following a storm event. The unit can be operated by a jetter van or truck, or run from a boosted final effluent or potable water supply. This allows you to maintain your assets without operators having to enter confined spaces. Civils are dramatically reduced in new designs as low ceiling heights can be used. Our system can be used to clean the walls as well as the tank floor and can be cleaned at any time day or night and especially following EVERY storm event.

# TANKMASTER

## STORM TANK CLEANING

### Technical Specification

MATERIALS OF CONSTRUCTION	316 stainless steel. Nitrile 'O' rings.
WEIGHT	2.3kg (TM 400) 9.5kg (TM600)
INLET	1" BSPP (TM400) & 1 1/2" BSPP (TM600)
WATER SOURCE	Final effluent or portable water

The TANKMASTER is self powered by the cleaning medium. From a known pressure, read off from the chart below the flow rate and cleaning radius:

TANKMASTER 400 - WASH RADIUS OF 7 METRES		
NOZZLE DIAMETER	PRESSURE BAR	FLOW m <sup>3</sup> PER HOUR
4 x 6.5mm	6	9
	8	10

TANKMASTER 600 - WASH RADIUS OF 10 METRES		
NOZZLE DIAMETER	PRESSURE BAR	FLOW m <sup>3</sup> PER HOUR
4 x 8mm	6	28
	8	35.5

### Operation

Unique in the industry, the TANKMASTER utilises high accuracy nozzles to apply wash water directly to the soiled tank surface. The unit progressively indexes as it sweeps the jets over the tank forcing the soil to be lifted off and washed into the pump chamber. Units can be installed on davits over circular and rectangular tanks or ceiling mounted within retention sewers. Any size of tank can be accommodated.

### Engineered Systems

BWI have extensive experience in providing the mounting framework and dedicated booster pump sets, controls and installation. Please contact us for a reference list.

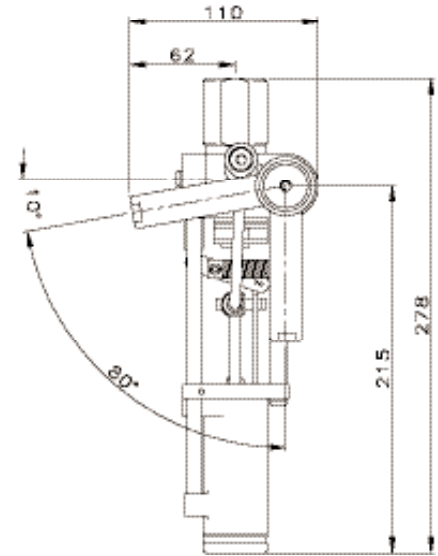

Tankmaster 400

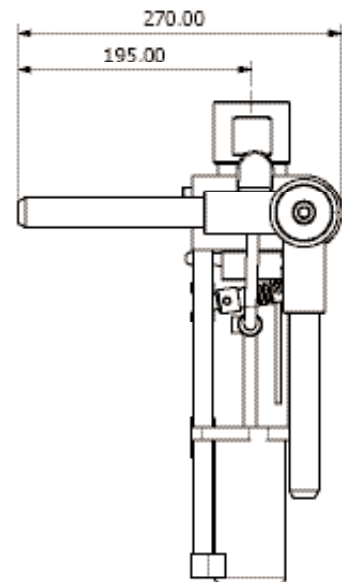

Tankmaster 600

For optimal efficiency use a pre-filter or strainer to prevent articulate clogging. We reserve the right to change this datasheet without notice. All data is provided as a guide only. Please contact our head office for detailed specifications.