



# AUTOMATED WET WELL WASHER

- **Powerful cleaning action**  
Removes sewerage derived litter quickly and efficiently from well walls, pumps, guide rails, etc.
- **Non-entry automated system**  
No requirement for man entry into CSO.
- **Breaks down fat from benching and chamber walls**  
Removes fat lines and odourous sewerage derived litter
- **Readily portable**  
Lightweight design ensures ease of handling and storage



### Versatile and Unique

The WELLMASTER is used within wet well chambers to remove solids that are left on walls, pumps, guide rails, etc, and return them to the water. The unit can be operated by a jetter van or truck, or run automatically from a dedicated booster pump set. This allows you to dramatically cut down operator costs and guarantee greater numbers of wet wells are cleaned. Clean wet wells prolong asset life, reduce odours and improve operator conditions.

# WELLMASTER

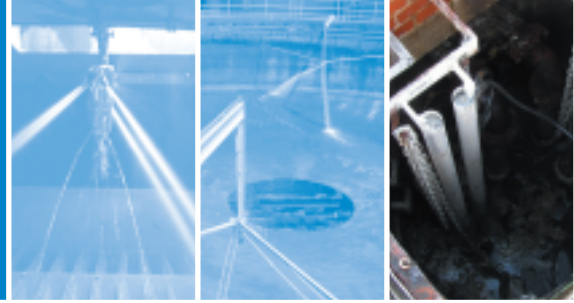

## WET WELL CLEANING

### Technical Specification

MATERIALS OF CONSTRUCTION	316 stainless steel mechanisms. Polypropylene case. Nitrile 'O' rings.
WEIGHT	5kg
NOZZLES	316 Stainless Steel
INLET	1" BSPP

The WELLMASTER is self powered by the cleaning medium. From a known pressure, read off from the chart below the flow rate and cleaning radius:

NOZZLE CONFIG.	PRESSURE BAR	FLOW LPM	M <sup>2</sup> PER WASH*	CLEANING RADIUS (M)	WETTING RADIUS (M)
4 x 3mm <sup>2</sup>	6	52	0.26	7	9
	8	60	0.3	7	11
	10	67	0.34	8	12
4 x 4mm <sup>2</sup>	12	72	0.36	8	12
	6	82	0.41	7	9
	8	92	0.46	7	11
	10	103	0.52	8	12
	12	112	0.56	8	12

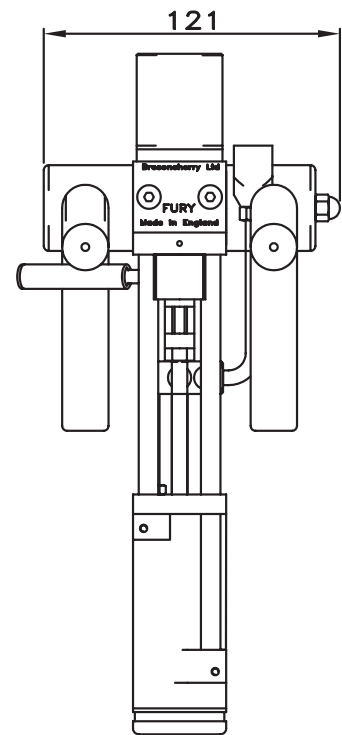

### Operation

Unique in the industry, the WELLMASTER utilises high accuracy nozzles to apply wash water directly to the soiled well surfaces. The unit progressively indexes as it sweeps the jets over the well. Any size well can be accommodated.

### Mounting

The unit is self supporting on a box section manhole frame. This sits over the well manhole and has a downward orbiting wash pattern.

### Engineered Systems

BWI have extensive experience in providing the mounting framework and dedicated booster pump sets and controls. Please contact us for a reference list.

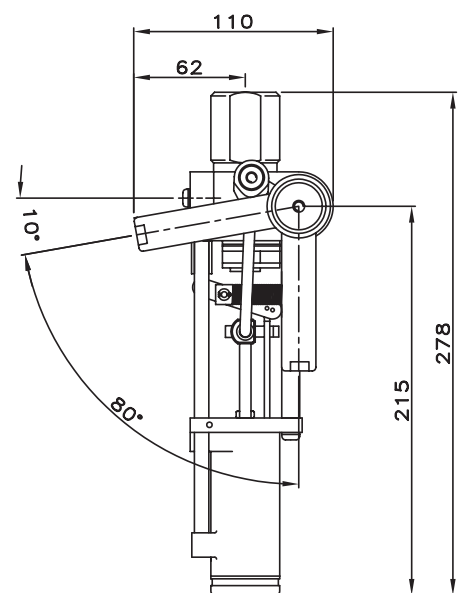

For optimal efficiency use a pre-filter or strainer to prevent articulate clogging. We reserve the right to change this datasheet without notice. All data is provided as a guide only. Please contact our head office for detailed specifications.

